

elumen8

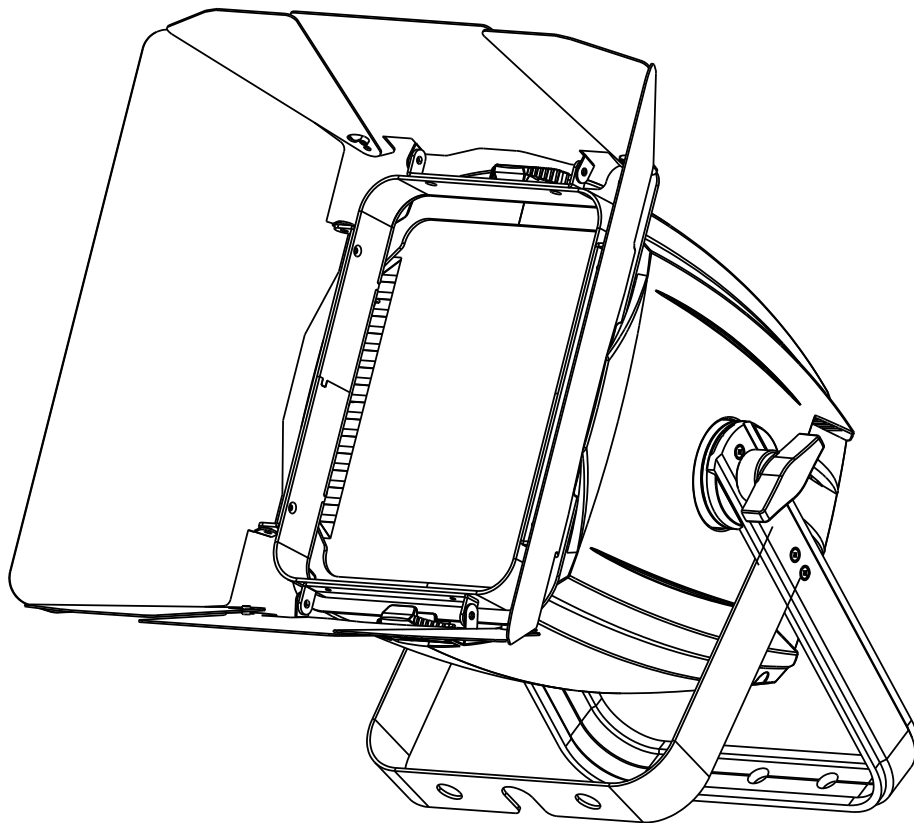

Order Code: ELUM121

User Manual

www.prolight.co.uk

CONTENTS

1. Safety Introduction	2
2. Technical Specifications	3
3. How To Set The Fixture	4
3.1 Control Panel.....	4
3.2 Barn Door Installation	5
3.3 Main Functions.....	6
4. How To Control The Unit	12
4.1 DMX Control.....	12
4.2. DMX 512 Configuration.....	13
4.3. DMX 512 Connections.....	15
5. Troubleshooting.....	16
6. Fixture Cleaning	16

1. Safety Introduction



WARNING

Please read carefully the instructions which include important information about installation, usage and maintenance.



DANGER!
Safety hazard.
Risk of severe injury or death.



DANGER!
Hazardous voltage. Risk of lethal or severe electric shock



WARNING!
Fire hazard.



WARNING!
LED light emission. Risk of eye injury.



WARNING!
Burn hazard. Hot surface. Do not touch.



WARNING! Refer to user manual.

- Please keep this User Guide for future consultation. If you sell the unit to another user, be sure that they also receive this instruction booklet.
- Please unpack and check carefully there is no transportation damage before using the unit.
- Before operating, ensure that the voltage and frequency of power supply match the power requirements of the unit.
- You must ground the yellow/green conductor to earth in order to avoid electric shock.
- The unit is for indoor use only. Use only in a dry location.
- The unit must be installed in a location with adequate ventilation, at least 50cm from adjacent surfaces. Be sure that no ventilation slots are blocked.
- Please disconnect mains power before replacement or servicing.
- Please make sure there are no flammable materials close to the unit while operating as they may be a fire hazard.
- Use a safety cable when installing this unit.
- Maximum ambient temperature is $T_a: 40^{\circ}\text{C}$. DO NOT operate it where the temperature is higher than this.
- Unit surface temperature may reach up to 55°C . DO NOT touch the housing with bare-hands during operation. Turn off the power and allow 15 minutes for the unit to cool down before replacing or servicing.
- In the event of a serious operating problem, stop using the unit immediately. Never try to repair the unit by yourself. Repairs carried out by unskilled people can lead to damage or malfunction. Please contact the nearest authorized technical assistance center. Always use the same type

spare parts.

- DO NOT touch any cables during operation as the high voltage may cause electric shock.

Warning:

- To prevent or reduce the risk of electrical shock or fire, do not expose the unit to rain or moisture.
- The housing or front lens must be replaced if they are visibly damaged.

Installation:

The unit should be mounted via its screw holes to a bracket. Always ensure that the unit is firmly fixed to avoid vibration and slipping while operating. Make sure that the structure to which you are attaching the unit is secure and is able to support a weight of 10 times of the unit's weight. Also always use a safety cable that can hold 12 times of the weight of the unit when installing the fixture.

The equipment must be installed by professionals. It must be installed in a place where is out of the reach of people and no one can pass by or under it.

2. Technical Specifications

- ◆ Powerful cyclorama projector,with innovative optics,featuring a high power quad colour LED and 90°x 113°beam angle, delivering excellent colour mixing with an even and wide-field projection.
- ◆ Control Mode: DMX, Master/Slave
- ◆ DMX Channels: 4 / 9.
- ◆ 0~100% smooth dimming with 2 speed options.
- ◆ Frame for the use of colour filters and barn doors.
- ◆ Variable strobe speed.
- ◆ LCD display for easy navigation.

◇ Power Voltage:	AC 100 ~ 240V, 50/60Hz
◇ Power Consumption:	155W
◇ Light Sources:	1 x 150W RGBW LED
◇ Beam angle:	90° x 113°
◇ Weight:	6.2 Kgs
◇ Dimension:	425 x 364 x 419mm

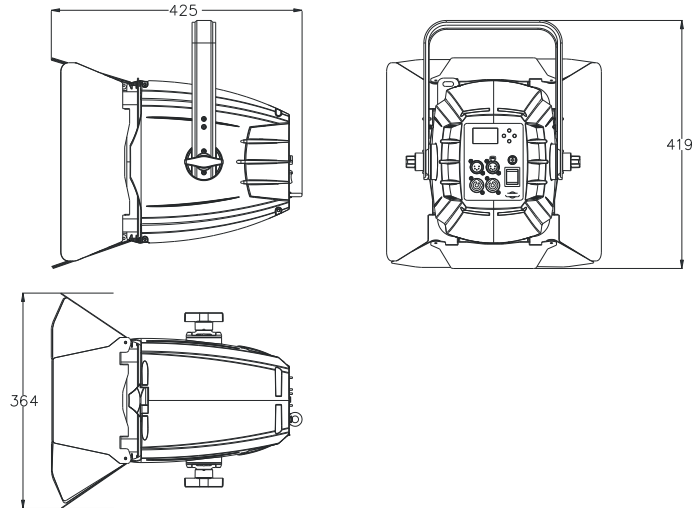

3. How To Set The Fixture

3.1 Control Panel

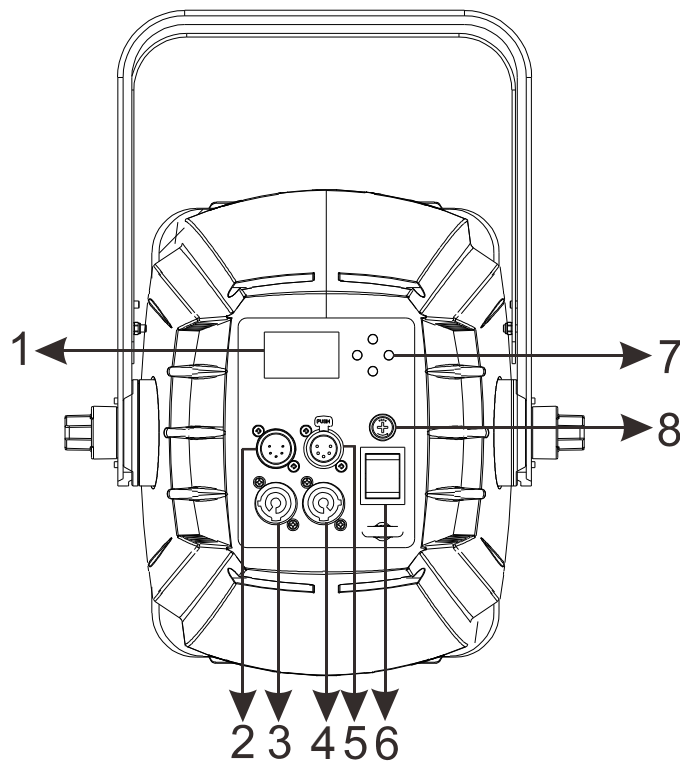

1. **Display:** Used to show the various menus and selected functions;
2. **DMX IN :** For DMX 512 linking, use 5-pin XLR cables.
3. **POWER IN:** Used to connect mains supply power;
4. **POWER OUT:** Used to connect to supply power;

5. **DMX OUT:** For DMX 512 linking, use 5-pin XLR cables to link to the next unit.

6. **Power Switch:** Turns the power On/Off.

7. **Buttons:**

MENU	To select the programming functions
DOWN	To go backward in the selected functions
UP	To go forward in the selected functions
ENTER	To confirm the selected functions

8. **Fuse (T3.15A):** Protects the unit from over-voltage or short circuit.

3. 2 Frame for Barn Door Installation

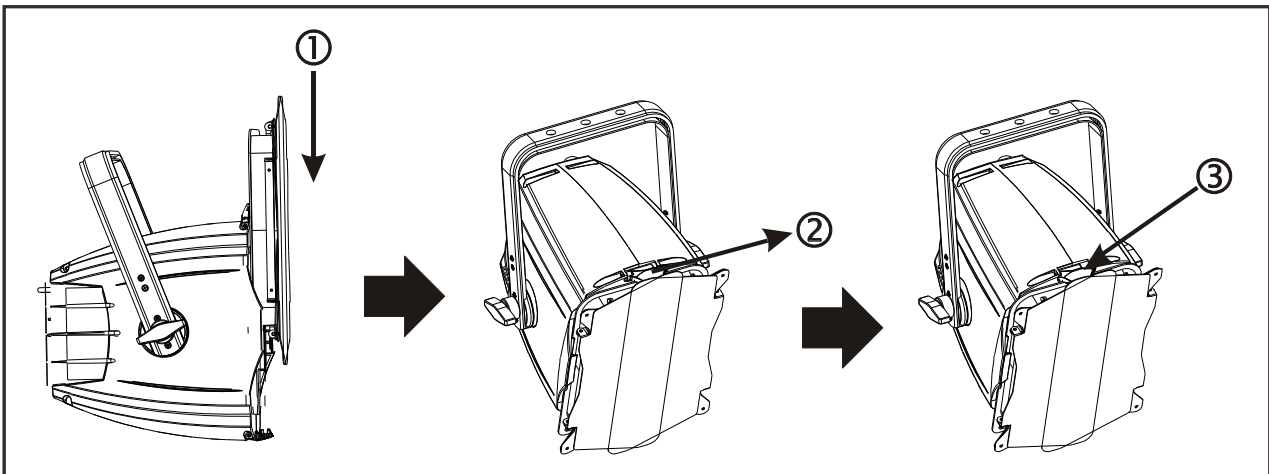

Please insert the Barn Door into the outer most slot, from the topside of the fixture as per arrow

①. To secure in place, fasten the lock (**Note:** Please take care to ensure the Barn Door is securely located inside the left, right and lower barn door rails);

Finally, as per the arrow ②, (**Note:** the lock must slide to the right in order to open/close) flip down the lock cap again as arrow ③, in order to fasten the Barn Door. For best practice, secure the barn door using a suitable safety bond fastened to the eye located on the barn door frame (safety bond not supplied).

3.3 Main Functions

Press the **MENU** button into menu mode, press the **UP** and **DOWN** buttons until the required function is shown on the display. Select the function by pressing the **ENTER** button. Use the **UP** and **DOWN** buttons to choose the submenu, press the **ENTER** button to store and automatically return to the last menu. Press the **MENU** button or leave the unit idle for one minute to exit the menu mode.

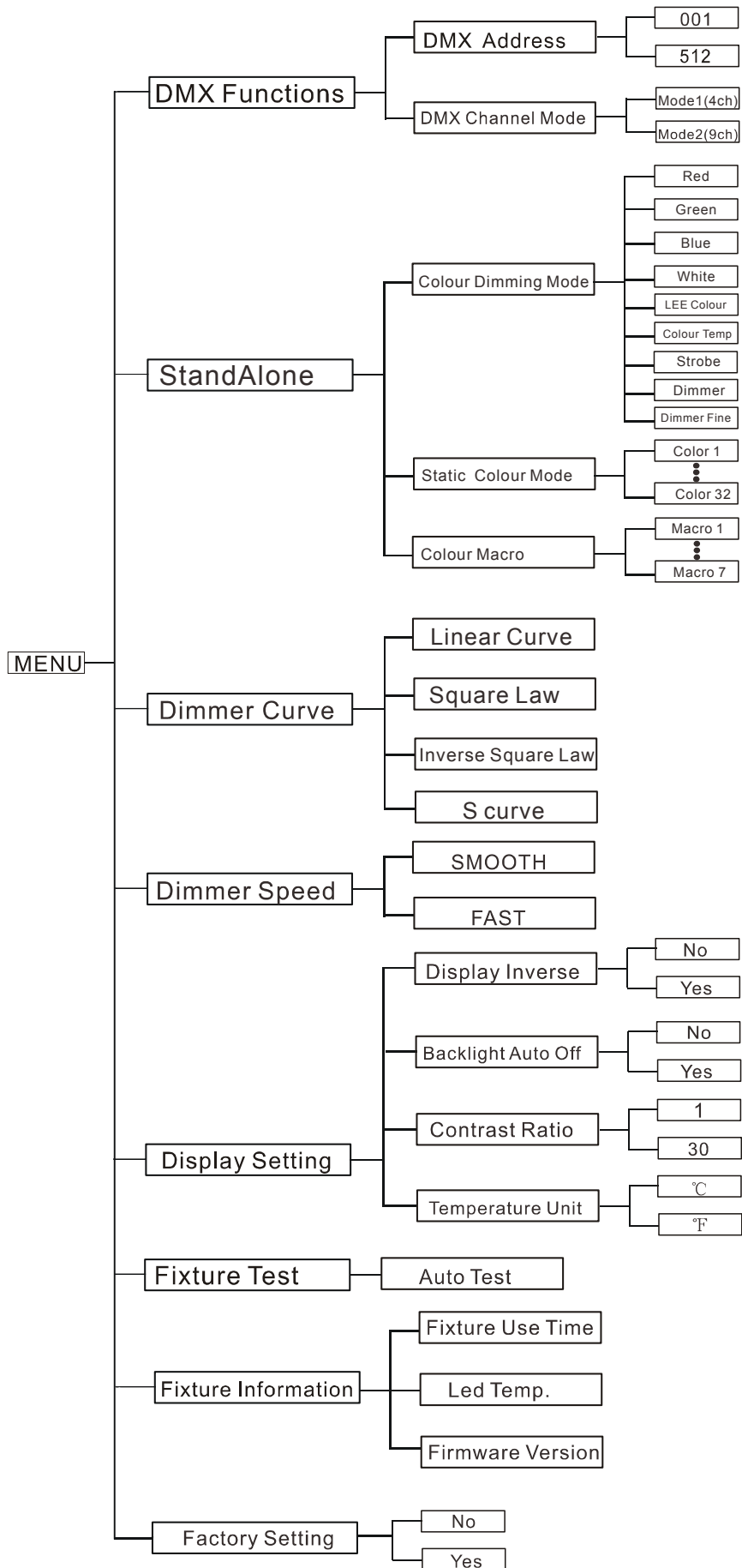

DMX Settings

To select **DMX Settings**, press the **ENTER** button to confirm, use the **UP/DOWN** buttons to select **DMX Address** or **Channel Mode**

DMX Address

To select **DMX Address**, press the **ENTER** button to confirm. Use the **UP/DOWN** buttons to adjust the address from **1** to **512**, press the **ENTER** button to setup. To go back to the functions without any changes press the **MENU** button again. Press and hold the **MENU** button for about one second or wait for one minute to exit the menu mode.

Channel Mode

To select **Channel Mode**, press the **ENTER** button to confirm. Use the **UP/DOWN** buttons to select **Mode 1 (4 ch)** or **Mode 2 (9 ch)** To go back to the functions without any changes press the **MENU** button again. Press and hold the **MENU** button for about one second or wait for one minute to exit the menu mode.

Stand Alone

To select **Stand Alone**, press the **ENTER** button to confirm, use the **UP/DOWN** buttons to select **Colour Dimming Mode**, **Static Colour Mode** or **Colour Macro**.

Colour Dimming Mode

To select **Colour Dimming Mode**, press the **ENTER** button to confirm. When you select **Mode 1 (4 ch)**, use the **UP/DOWN** buttons to select **Red, Green, Blue** or **White**. If you choose **Mode 2 (9 ch)**, use the **UP/DOWN** buttons to select **Red, Green, Blue, White, Lee compatible colour, Colour-Temp, Strobe, Dimmer** or **Dimmer fine** mode, press enter, use the **UP/DOWN** button to select desired value **000-255**, press **ENTER** button to save, **when using this mode please make sure Strobe is set to value 255**, do not press **MENU** as this action will exit the stand-alone mode, press **ENTER** to save. The fixture will remember the stand-alone mode set even after a power off and back on cycle.

Static Colour Mode

To select **Static Colour Mode**, press the **ENTER** button to confirm. Use the **UP/DOWN** button to select **Color 1~Color 32** mode, do not press **MENU** as this action will exit stand-alone mode selected, press **ENTER** to save. The fixture will remember the stand-alone mode set even after a power off and back on cycle.

Colour Macro Mode

To select **Colour Macro**, press the **ENTER** button to confirm. Use the **UP/DOWN** button to select **Macro 1~Macro 7** mode, the seven Macro's are all a colour scrolling fade with macro 1 the fastest and macro 7 the slowest, do not press **MENU** as this action will exit stand-alone mode selected, press **ENTER** to save. The fixture will remember the stand-alone mode set even after a power off and back on cycle.

Dimmer Curve

To select **Dimmer Curve**, press the **ENTER** button to show the **DIMMER CURVE** on the display, the current setting will be highlighted on the display, use the **UP/DOWN** button to select **Linear**, **Square Law**, **Inverse Square Law** or **S curve**. To go back to the functions without any changes press the **MENU** button again. Press and hold the **MENU** button for about one second or wait for one minute to exit the menu mode.

Dimmer Modes:

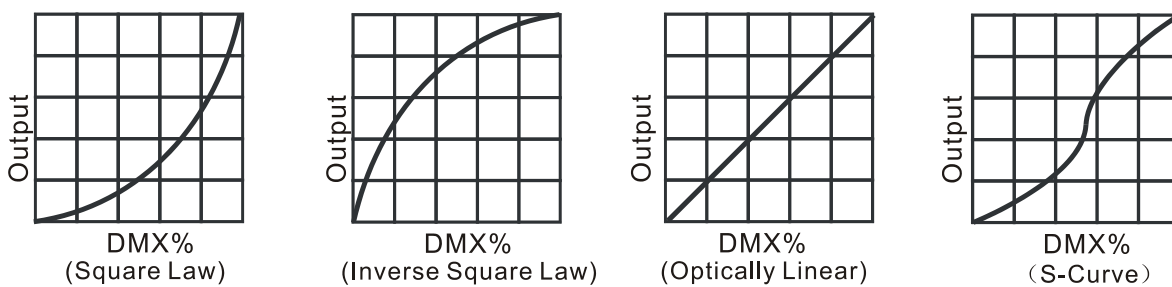

Square Law: Light intensity control is finer at low levels and coarser at high levels.

Inverse Square Law: Light intensity control is coarser at low levels and finer at high levels.

Linear: The increase in light intensity appears to be linear as DMX value is increased.

S-curve: Light intensity control is finer at low and high levels and coarser at medium levels.

Dimmer Speed

To select **Dimmer Speed** press the **ENTER** button to confirm, current mode will be highlighted on the display, use the **UP/DOWN** button to select **SMOOTH** (dimmer speed smooth) or **FAST**(dimmer speed fast) press the **ENTER** button to setup. To go back to the functions without any changes press the **MENU** button again. Press and hold the **MENU** button for about one second or wait for one minute to exit the menu mode.

Display Settings

Enter menu mode, select **Display Settings**, press **ENTER** button to confirm, use the **UP/DOWN** button to select **Display Inverse**, **Backlight Auto Off**, **Contrast Ratio** or **Temperature Unit**.

Display Inverse

To select **Display Inverse**, press the **ENTER** button to confirm, current mode will be highlighted on the display, use the **UP/DOWN** button to select the **No** (normal display) or **Yes** (inverse display), press the **ENTER** button to setup. To go back to the functions without any changes press the **MENU** button again. Press and hold the **MENU** button for about one second or wait for one minute to exit the menu mode.

Backlight Auto Off

To select **Backlight Auto Off**, press the **ENTER** button to confirm, current mode will be highlighted on the display, use the **UP/DOWN** button to select **Yes** (display goes off one minute after exiting menu mode) or **No** (display always on), press the **ENTER** button to save. To go back to the functions without any changes press the **MENU** button again. Press and hold the **MENU** button for about one second or wait for one minute to exit the menu mode.

Contrast Ratio

To select **Contrast Ratio**, press the **ENTER** button to confirm, current mode will be highlighted on the display, use the **UP/DOWN** button to adjust the value from 1 to 30, press the **ENTER** button to save. To go back to the functions without any changes press the **MENU** button again. Press and hold the **MENU** button for about one second or wait for one minute to exit the menu mode.

Fixture Test

To select **Fixture Test** press the **ENTER** button to confirm, use the **UP/DOWN** button to select the **Auto Test** Mode, press the **ENTER** button to run the built-in test routine. To go back to the functions without any changes press the **MENU** button again. Press and hold the **MENU** button for about one second or wait for one minute to exit the menu mode.

Fixture Information

Enter menu mode, select **Fixture Information**, press the **ENTER** button to confirm, use the **UP/DOWN** button to select the **Fixture Use Time**, **LED Temp.** or **Firmware Version**.

Fixture Use Time

To select **Fixture Use Time**, press the **ENTER** button to confirm, and the total number of fixture hours will show on the display. To go back to the functions without any changes press the **MENU** button again. Press and hold the **MENU** button for about one second or wait for one minute to exit the menu mode.

LED Temp.

To select **LED Temp.**, press the **ENTER** button to confirm, the current running temperature of the fixture will show on the display. To go back to the functions without any changes press the **MENU** button again. Press and hold the **MENU** button for about one second or wait for one minute to exit the menu mode.

Firmware Version

To select **Firmware Version**, press the **ENTER** button to confirm, the software version will show on the display. To go back to the functions without any changes press the **MENU** button again. Press and hold the **MENU** button for about one second or wait for one minute to exit the menu mode.

Factory Setting

Select **Factory Setting**, press the **ENTER** button to confirm, present mode will show on the display. Use the **DOWN** and **UP** button to select the **No** or **Yes** (Switch back to default settings). To go back to the functions without any changes press the **MENU** button again. Press and hold the **MENU** button for about one second or wait for one minute to exit the menu mode.

4. How To Control The Unit

You can operate the unit by this ways: DMX controller

You do not need to turn the unit off when you change the DMX address, the new DMX address setting will take effect immediately.

4.1 DMX Controller

If you use a universal DMX controller to control the units, you have to set DMX address from 1 to 512 so that the units can receive DMX signal.

Press MENU button to enter the menu mode, select **DMX Functions** and press the ENTER button to confirm. Use the UP and DOWN buttons to select **DMX Address**, press the ENTER button to confirm, the present address will blink on the display, use the UP and DOWN buttons to adjust the address from 1 to 512, press the ENTER button to store. Press and hold the **MENU** button for about one second or wait for one minute to exit the menu mode.

Please refer to the following diagram to address your DMX 512 channels for the first 4 units.

Channel mode	Unit 1 Address	Unit 2 Address	Unit 3 Address	Unit 4 Address
4 channels	1	5	9	13
9 channels	1	10	19	28

4.2. DMX 512 Configuration

4 Channel Mode:

CHANNEL	VALUE	FUNCTIONS
1	000 ~ 255	RED 0% → 100%
2	000 ~ 255	GREEN 0% → 100%
3	000 ~ 255	BLUE 0% → 100%
4	000 ~ 255	WHITE 0% → 100%

9 Channel Mode:

CHANNEL	VALUE	FUNCTIONS
1	000 ~ 255	RED 0% → 100%
2	000 ~ 255	GREEN 0% → 100%
3	000 ~ 255	BLUE 0% → 100%
4	000 ~ 255	WHITE 0% → 100%
5	000 001 ~ 006 007 ~ 013 014 ~ 020 021 ~ 027 028 ~ 034 035 ~ 041 042 ~ 048 049 ~ 055 056 ~ 062 063 ~ 069 070 ~ 076 077 ~ 083 084 ~ 090 091 ~ 097 098 ~ 104	COLOUR MACRO Open LEE 790 – Moroccan Pink LEE 157 – Pink LEE 332 – Special Rose Pink LEE 328 – Follies Pink LEE 345 – Fuchsia Pink LEE 194 – Surprise Pink LEE 181 – Congo Blue LEE 071 – Tokyo Blue LEE 120 – Deep Blue LEE 079 – Just Blue LEE 132 – Medium Blue LEE 200 – Double CT Blue LEE 161 – State Blue LEE 201 – Full CT Blue LEE 202 – Half CT Blue

	105 ~ 111 112 ~ 118 119 ~ 125 126 ~ 132 133 ~ 139 140 ~ 146 147 ~ 153 154 ~ 160 161 ~ 167 168 ~ 174 175 ~ 181 182 ~ 188 189 ~ 195 196 ~ 202 203 ~ 209 210 ~ 216 217 ~ 223 224 ~ 255	LEE 117 – Steel Blue LEE 353 – Lighter Blue LEE 118 – Light Blue LEE 116 – Medium Blue Green LEE 124 – Dark Green LEE 139 – Primary Green LEE 089 – Moss Green LEE 122 – Fern Green LEE 738 – JAS Green LEE 088 – Lime Green LEE 100 – Spring Yellow LEE 104 – Deep Amber LEE 179 – Chrome Orange LEE 105 – Orange LEE 021 – Gold Amber LEE 778 – Millennium Gold LEE 135 – Deep Gold Amber LEE 164 – Flame Red
6	000 ~ 255	COLOR TEMPERATURE 2800K – 6000K
7	000 ~ 007 008 ~ 015 016 ~ 131 132 ~ 139 140 ~ 181 182 ~ 189 190 ~ 231 232 ~ 239 240 ~ 247 248 ~ 255	STROBE Off Open Strobe: Slow → Fast open Fast Close Slow Open Open Fast Open Slow Close Open Random Strobe Open
8	000 ~ 255	DIMMER 0-100%
9	000 ~ 255	DIMMER FINE 0-100%

4.3. DMX 512 Connections

The DMX 512 is widely used in intelligent lighting control, with a maximum of 512 channels.

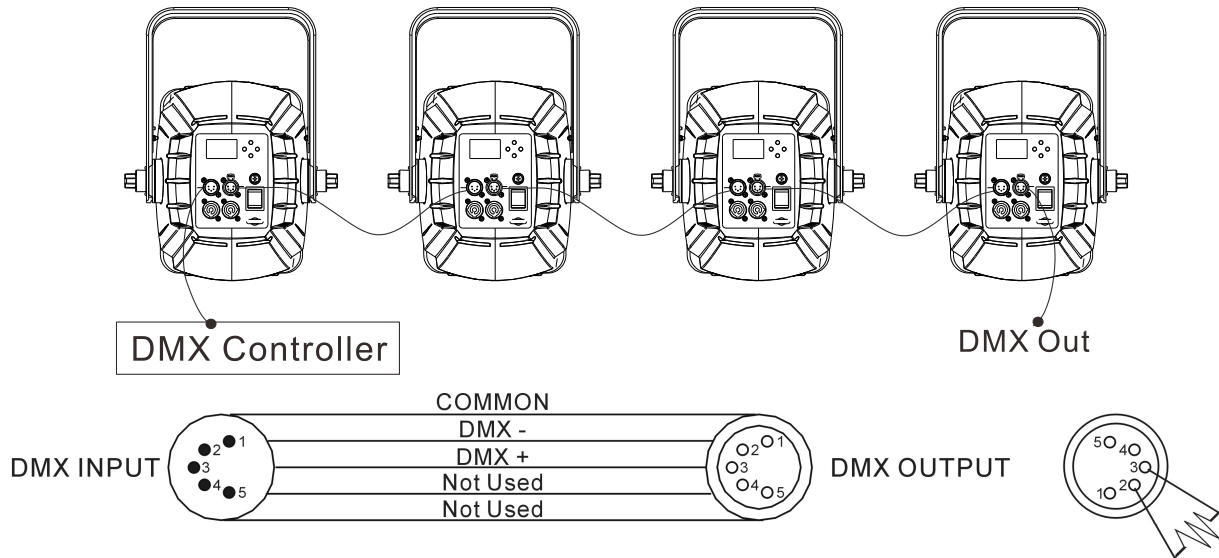

1. In the last unit, the DMX cable has to be terminated. Solder a 120-ohm 1/4W resistor into a XLR plug and insert into the last unit or purchase a ready made DMX terminator.
2. Connect the units together in a “daisy chain” with XLR cables from the output of the unit to the input of the next unit. The cable cannot be branched or split to a “Y” cable.
3. The DMX output and input connectors are a pass-through type to maintain the DMX circuit, when one of the units’ power is disconnected.
4. Each unit needs to have a DMX address to receive the data by the controller. The address number is between 0-511 (usually 0 & 1 are equal to 1).
5. The end of the DMX 512 system should be terminated to reduce signal errors.
6. DMX Wiring configuration:
 - 3 pin XLR: Pin 1: GND, Pin 2: Negative signal (-), Pin 3: Positive signal (+)
 - 5 pin XLR: Pin 1: GND, Pin 2: Negative signal (-), Pin 3: Positive signal (+), Pin4, Pin5 not used.

5. Troubleshooting

Following are a few common problems that may occur during operation. Here are some suggestions for easy troubleshooting:

A. The unit does not work, no light output and the fan does not work

1. Check the power connection and main fuse.
2. Check the power on LED to see if it is illuminated.

B. Not responding to DMX controller

1. DMX LED should be on. If not, check DMX connectors and cables to see if they are connected correctly.
2. If the DMX LED is on and no response to the desk, check the address settings and DMX polarity.
3. Try another DMX controller.

6. Fixture Cleaning

Cleaning:

The cleaning of internal and external optical lenses and/or mirrors must be carried out periodically to optimize light output. Cleaning frequency depends on the environment in which the fixture operates: damp, smoky or particularly dirty surrounding can cause greater accumulation of dirt on the unit's optics.

- Clean with soft cloth and use normal glass cleaner.
- Always dry the parts carefully.
- Clean the external optics at least every 20 days. Clean the internal optics at least every 30/60 days.

Declaration of Conformity

We declare that our products (lighting equipment) comply with the following specification and bears CE mark in accordance with the provision of the Electromagnetic Compatibility (EMC) Directive 89/336/EEC.

EN55103-1: 2009 ; EN55103-2: 2009; EN62471: 2008;
EN61000-3-2: 2006 + A1:2009 + A2:2009; EN61000-3-3: 2008.

&

Harmonized Standard

EN 60598-1:2015; EN 60598-2-17:1989 + A2:1991; EN 62471:2008;
EN 62493: 2010
Safety of household and similar electrical appliances
Part 1: General requirements

Innovation, Quality, Performance