

FLEXOLED

www.prolight.co.uk



TRI COLOUR 5M LED STRIP INSTALL KIT

ORDER CODE: FLEX01PK1

USER MANUAL

Installation

Installation

The tri colour strip can only be controlled via the supplied I.R. remote for up to 5m of the supplied strip.

- Before installation or maintenance, please ensure that the power is switched off at the mains.
- Please ensure the polarity and all connections are correct before switching on the power supply.
- Working temperature : $-25^{\circ}\text{C} \sim +60^{\circ}\text{C}$.
- IP-54 rated resin coating, system for indoor use only.

Installation instructions

- 1, Isolate from the power supply before installation or maintenance.
- 2, Only the supplied DC 12V power supply must be used with the tri colour strip.
- 3, Please follow the diagram below to connect the tri colour strip together.
- 4, If you connect the strip to the control box the wrong way round the strip will not light up. Unplug the strip connector and turn over.

Diagram for connection:

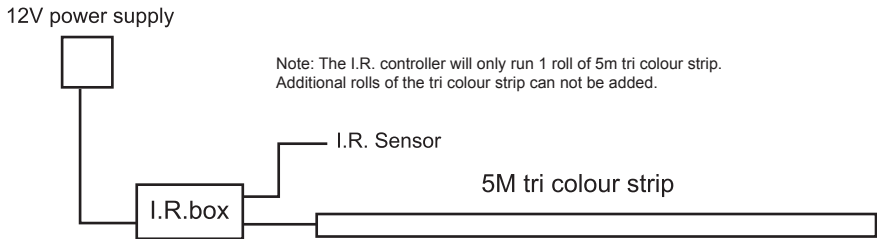

- 4, The FlexoLED Tri colour strip can be cut at the scissor mark printed on the tape at regular intervals.

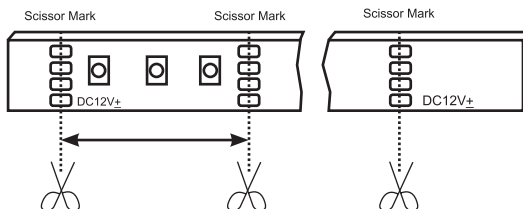

Features:

- Built-in programmes
- 16 static colour buttons
- Adjustable brightness/speed buttons
- On/off button
- Programme selection buttons
- Static colour, change and fade modes
- Infra-red remote (included)

Specification:

- Power supply: DC 12V (adapter included)
- Dimensions: 70 x 35 x 21mm
- Weight: 0.2Kg

Infra-red remote:

- Power Supply: Lithium CR2032 battery (supplied)
- Dimensions: 83 x 51 x 7mm
- Weight: 0.2g

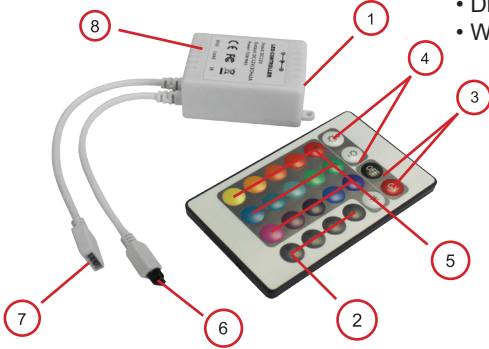

Identification:

- 1, Power input socket
- 2, Mode buttons
- 3, Power on/off button
- 4, Brightness/speed buttons
- 5, Static colour selection buttons
- 6, I.R. sensor
- 7, Output connector
- 8, Power supply

Note: Before use, please remove the battery isolator for the I.R. remote to work.



This LED controller has four different functions to choose from.

Programme select function

When you first power up the I.R. controller the colour strip will automatically come on with it. To scroll through the built-in programmes, simply press any one of the “**mode**” buttons.

Mode buttons:

Flash = 3 colour change, Strobe = white fade, Fade = 7 colour fade, Smooth = 7 colour change

Note: To change the speed of any of the above modes, use the “**brightness/speed**” buttons to increase or decrease the mode speed.

Static colour selection function

To set the RGB colour strip into one of the static colours, simply press any of the 16 static colour buttons until you have obtained the desired effect.

Brightness function

Whilst the unit is showing any of the static colours you can use the “**brightness/speed**” buttons to increase or decrease the brightness of the LEDs.

On/standby function

Whilst the unit is running in any mode the colour strip can be turned off by using the “**OFF**” button. To turn the colour strip back on simply press the “**ON**” button again.

Note: When you turn off the power, upon powering back up the colour strip will continue to show the same programme/colour that was shown when powered off.

FlexoLED F01 Tri Colour Strip

Power Supply	DC 12V
SMD LED	150/5mtr
Beam angle	120 degrees
Dimensions	10 x 5000mm
Weight	0.23Kgs

FLEXOLED

www.prolight.co.uk
