



ATMOTECH



PROFESSIONAL ATMOSPHERIC EFFECTS



Order Code: FOG05

USER MANUAL



WARNING

**FOR YOUR OWN SAFETY, PLEASE READ THIS USER MANUAL CAREFULLY
BEFORE YOUR INITIAL START-UP!**



CAUTION!

**Keep this equipment away from rain,
moisture and liquids.**



SAFETY INSTRUCTIONS

Every person involved with the installation, operation & maintenance of this equipment should:

- Be competent
- Follow the instructions of this manual



**CAUTION! TAKE CARE USING THIS EQUIPMENT!
HIGH VOLTAGE-RISK OF ELECTRIC SHOCK!!**



Before your initial start-up, please make sure that there is no damage caused during transportation. Should there be any, consult your dealer and do not use the equipment.

To maintain the equipment in good working condition and to ensure safe operation, it is necessary for the user to follow the safety instructions and warning notes written in this manual.

Please note that damages caused by user modifications to this equipment are not subject to warranty.

IMPORTANT:

The manufacturer will not accept liability for any resulting damages caused by the non-observance of this manual or any unauthorised modification to the equipment.

- Never let the power-cable come into contact with other cables. Handle the power-cable and all mains voltage connections with particular caution!
- Never remove warning or informative labels from the equipment.
- Do not open the equipment and do not modify the equipment.
- Only use the equipment indoors.
- Do not expose to flammable sources or gases.
- Always disconnect the power from the mains when equipment is not in use or before cleaning! Only handle the power-cable by the plug. Never pull out the plug by pulling the power-cable.
- Make sure that the available voltage is between 220V/240V.
- Make sure that the power-cable is never crimped or damaged. Check the equipment and the power-cable periodically.
- If the equipment is dropped or damaged, disconnect the mains power supply immediately. Have a qualified engineer inspect the equipment before operating again.
- If the equipment has been exposed to drastic temperature fluctuation (e.g. after transportation), do not switch it on immediately. The arising condensation might damage the equipment. Leave the equipment switched off until it has reached room temperature.
- If your product fails to function correctly, discontinue use immediately. Pack the unit securely (preferably in the original packing material), and return it to your Prolight dealer for service.
- Only use fuses of same type and rating.
- Repairs, servicing and power connection must only be carried out by a qualified technician. **THIS UNIT CONTAINS NO USER SERVICEABLE PARTS.**
- **WARRANTY:** One year from date of purchase.

OPERATING DETERMINATIONS

If this equipment is operated in any other way, than those described in this manual, the product may suffer damage and the warranty becomes void.

Incorrect operation may lead to danger e.g. short-circuit, burns, electric shocks etc.

Do not endanger your own safety and the safety of others!

Incorrect installation or use can cause serious damage to people and property.

Before filling the unit disconnect the mains. Never fill with hot liquids.

Only use high quality, water based smoke fluid recommended by the manufacturer  Other smoke fluids may cause clogging and void the warranty.

Always make sure there is sufficient smoke fluid in the tank. Operating this smoke machine without smoke fluid will cause damage to the pump as well as over heating of the heater.

Operate the unit only after you have familiarized yourself with its functions, Do not permit operation by persons not qualified for operating the unit and always drain the tank and use the original packaging if the unit is to be transported.

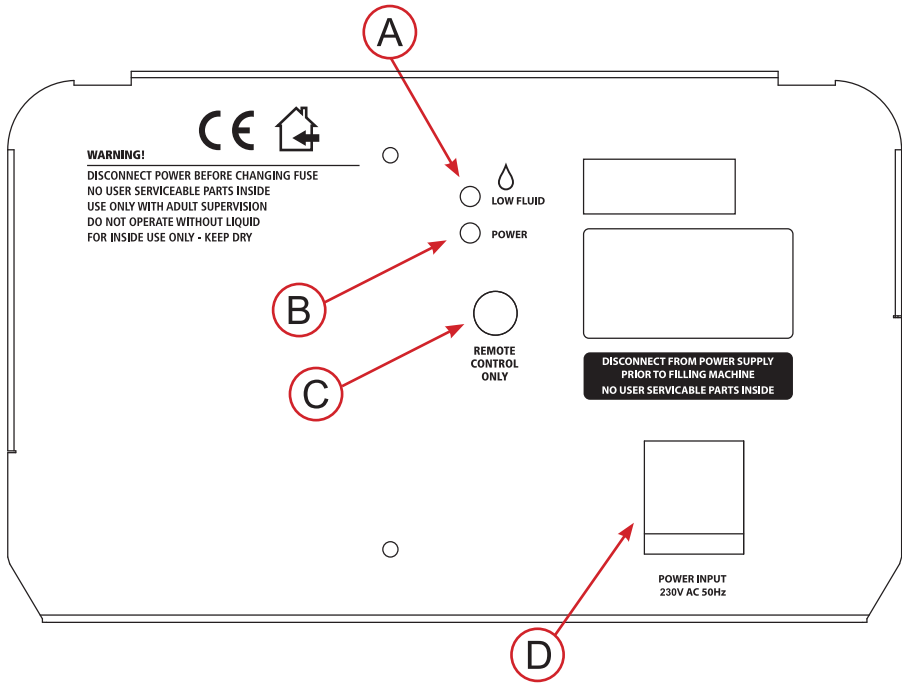

TC-4 Controller

Identification:

- A, Low fluid indicator
- B, Power indicator
- C, Remote socket
- D, IEC power socket

STARTING OPERATION

The fluid tank of the unit needs to be filled with haze fluid before switching on. Always disconnect it from the mains supply as fluid could be spilled.

Only use quality haze fluids recommended by your dealer. We recommend high quality  haze fluids. You must not use substances which are classified as **“DANGEROUS WORKING MATERIALS”** or **“FLAMMABLE FLUIDS”**.



If fluid should get inside the main housing, disconnect the unit from the mains immediately and consult a technician. Do not power on until fully cleaned, dried and checked by a service technician.

INSTALLATION

Install the unit in a well-ventilated area. Use in an insufficiently ventilated room can lead to the condensation of the smoke fluid. The resulting slippery surface can cause accidents. Keep a minimum distance of 1m around the unit.

Furthermore do not orientate the output nozzle directly in the direction of the audience’s eyes. In order to create the best effect, there should be a distance between the unit and the audience of at least 1.5m.

Only install the haze machine on fire resistant, scratch resistant and water resistant surfaces.

 <p style="margin: 0;">DANGER OF FIRE!</p> <p style="margin: 0;">When installing the unit, make sure there is no highly flammable material (decoration articles etc) within a minimum distance of 1m</p> 

Please make sure that the installation angle does not exceed 15° from the horizontal.

This unit is constructed for a free standing. Not suitable for overhead rigging.

TC-4 Controller

The TC-4 is suitable for use with the HZ-1000. The operation is as follows:

- 1, When the “**MANUAL FOGGING**” Green LED is OFF, this means that the haze machine is heating up. When the Green LED illuminates, the haze machine has heated up and is ready for use.
- 2, When the “**TIMERS**” and “**CONTINUOUS**” buttons are pressed OFF; the fogging duration can be adjusted by turning the “**DURATION**” knob.
The “**INTERVAL**” knob will adjust the amount of time in between every haze output.
- 3, When the “**CONTINUOUS**” button is pressed ON, the Red LED will light illuminate, the machine will now emit haze continuously until the Green LED goes OFF (indicating the hazer is heating up again), The “**TIMERS**” and “**MANUAL**” buttons are ineffective in this mode.
- 4, When the “**TIMERS**” button is pressed ON and the “**CONTINUOUS**” button is pressed OFF, the machine can be controlled manually by pressing the “**MANUAL**” button.

Note: Before removing or replacing the remote control unit, disconnect the power cable.

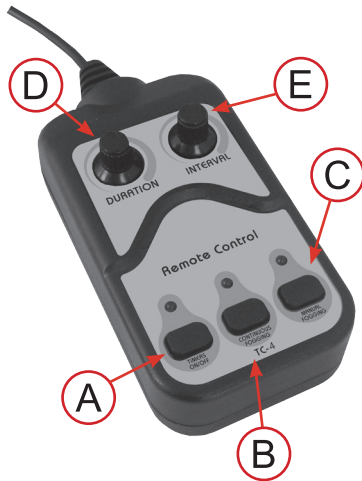

	Function	Instruction
A	Timers On/Off	Press this button and the timer of the interval output will stop and the red LED will illuminate.
B	Continuous Haze	Press this button and the fog machine will emit fog continuously and the red LED will illuminate.
C	Manual Haze	Press this button and it allows the operation to be controlled manually.
D	Duration (TC-1)	0.5s ~ 10s +/- 1s
E	Interval (TC-1)	9s ~ 280s +/- 20s
D	Duration (TC-4)	0.5s ~ 8s +/- 1s
E	Interval (TC-4)	2s ~ 150s +/- 10s



SPECIFICATIONS

Smoke output	1.500 cu.ft per minute
Warm up time	approx. 5 min
Tank capacity	2 L
Power consumption	700W
Power supply	230V
Dimensions	371 x 250 x 201mm
Weight	5.7kgs

English



**Correct Disposal of this Product
(Waste Electrical & Electronic Equipment)**

(Applicable in the European Union and other European countries with separate collection systems)

This marking shown on the product or its literature, indicates that it should not be disposed with other household wastes at the end of its working life. To prevent possible harm to the environment or human health from uncontrolled waste disposal, please separate this from other types of wastes and recycle it responsibly to promote the sustainable reuse of material resources.

Household users should contact either the retailer where they purchased this product, or their local government office, for details of where and how they can take this item for environmentally safe recycling.

Business users should contact their supplier and check the terms and conditions of the purchase contract. This product should not be mixed with other commercial wastes for disposal.







ATMOTECH

PROFESSIONAL ATMOSPHERIC EFFECTS

www.prolight.co.uk

